

2014 MOTD



Deals Gap, North Carolina • April 30-May 4, 2014

Event Guide

Table of Contents

Page 2	Event Communications
Page 3	Fontana Hours and Rec. Hall Map
Page 4-5	Safety on the Dragon
Page 5	Graham County Food Drive
Page 6	Vendor, Sponsor & Volunteer Acknowledgements
Page 7	Event Summary Page
Page 8-12	Event Guide
Page 13	Vendor Alley Map
Page 14	Vendor Schedule
Page 15	Restaurant Guide
Page 16	Emergency Info., History of MOTD, Fontana Village, Cherohala
Page 17	Local Waterfalls
Page 18	Area Maps
Page 19-20	Fontana Village Maps

EVENT COMMUNICATIONS

There will be a large Fontana Village map by the Wildwood Grill. For general communications between everyone attending, please monitor channel 7 sub-channel 21 on the FRS/GMRS radio. Please use this channel only to get in contact with other members of the group and refrain from playing music or having long conversations on 7-21. Doing so blocks the channel and prevents others from using it. In order to keep 7-21 clear for the group to use, it's best if you move your conversation to another channel instead of staying on 7-21. Below is a list of sub-channels for each local group attending.

2 Sub 15	----- Philly MINI	13 Sub 20	----- Midland MINI Motoring
3 Sub 8	----- MINI Skirts	14 Sub 7	----- Chicago MINI Club
4 Sub 9	----- Central Maryland MM	15 Sub 15	----- Queen City Coopers
5 Sub 21	----- MINICCI	16 Sub 10	----- Hampton Roads MINI Club
6 Sub 21	----- Michigan MINI	17 Sub 1	----- Upstatesminis - SC
6 Sub 9	----- QoC	17 Sub 21	----- Mid-South MINIacs
7 Sub 21	----- MOTD Main Channel	18 Sub 21	----- Kansas City MINI Enthusiasts
8 Sub 0	----- Gulf South Motoring	19 Sub 9	----- Bluegrass MINIs
9 Sub 0	----- Mid-Ohio Motoring	20 Sub 20	----- Tar Heel MINIs
10 Sub 4	----- Sunshine MINIs	20 Sub 21	----- "Drive and Eat"
10 Sub 11	----- CarlisleMINI	21 Sub 7	----- Mini NEO and MKO
11 Sub 11	----- Metroplex MINI	21 Sub 21	----- PittStop MINI - Bingo
12 Sub 14	----- Mid TN MINIs	22 Sub 22	----- DC Metro MINIs

Fontana Hours

There will be a "Fontana Map" banner displayed by the Wildwood Cafe

Fontana Lodging Check-Ins will be in the Main Lodge Building

MOTD Registration will be in the card room inside the Rec. Hall

(that is next to the bar in the Rec. Hall where the Group Dinners are Held)(see map below)

Fontana Food Tent in Vendor Alley: Fri. - Sat.: 11:00 am - 3:00 pm (In the Putt Putt Pavilion)

The Mountain View Bistro at the Lodge: Breakfast: 7:30 am - 11:30 am
Dinner: 5:30 pm - 9:00 pm - Mon-Thur.*
Dinner: 5:30 pm - 10:00 pm - Fri-Sat*
*(Reservations required for Dinner)

The Wildwood Grill will be open: Lunch/Dinner: 11:30 am - 10:00 pm Mon-Thur.
Lunch Dinner: 11:30 am - 11:00 pm Fri-Sat

** A Buffet Breakfast will be available at the Mountain View Bistro (Fri., Sat. and Sunday)

The General Store will be open Mon-Tuesday: 9:00 am - 6:00 pm
Wed.-Saturday 8:30 am - 9:00 pm
Sunday 9:00 am - 6:00 pm

Ice Cream Shop Thurs.-Sat. 1:00 pm - 9:00 pm

Overlook at the Top of the Dam Wed. - Sunday 10:00 am - 6:00 pm

Car Wash Locations: General Store Parking Lot
Small Parking Lot Across the Street from the Rec. Hall

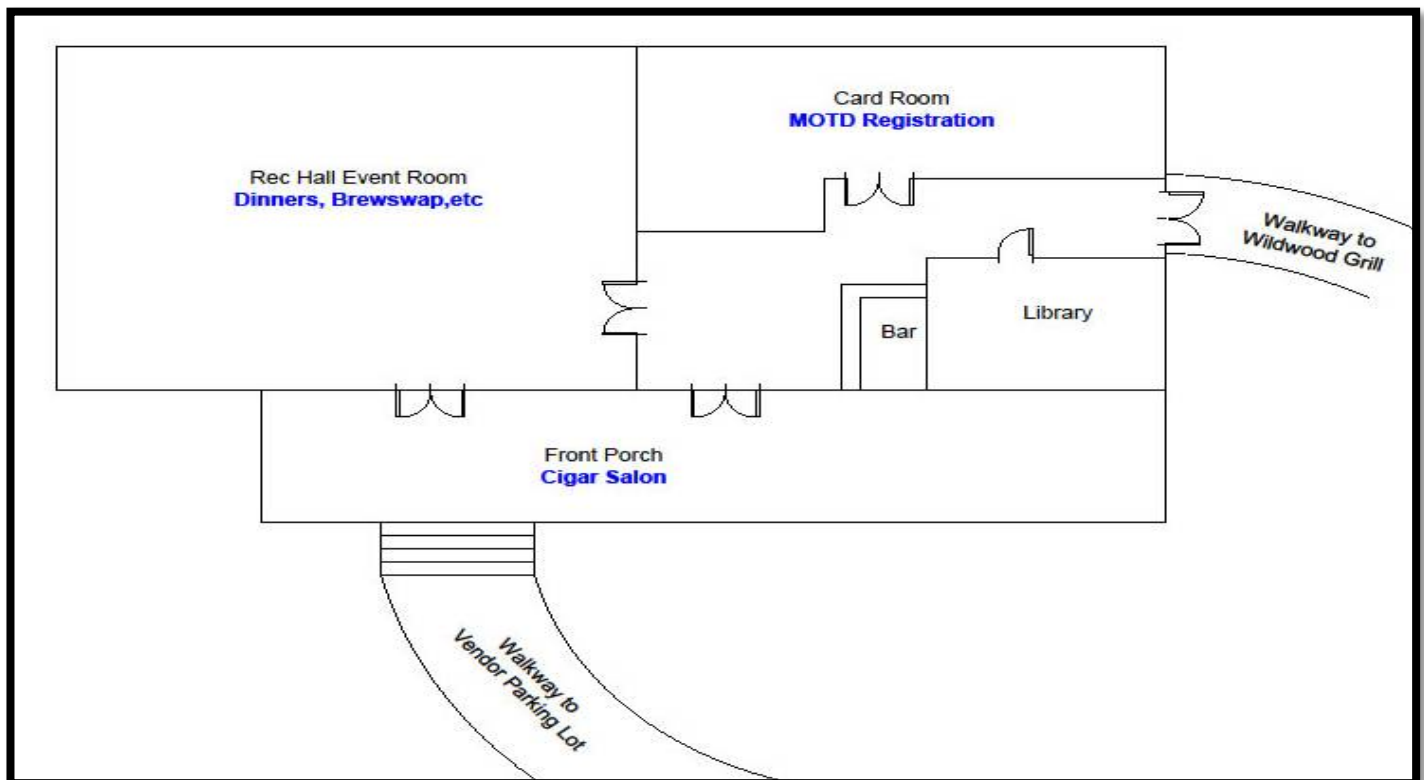

Safety on the Dragon!

Written by and used with permission of Ron Johnson from tailofthedragon.com

Drive the Dragon at your skill level - don't try to push it or keep up with faster vehicles.

STAY IN YOUR LANE, cutting the corners and taking chances that might appear "fun" while sitting in your easy chair, BEWARE, this style of driving the Dragon can cost you dearly. The challenge of the Dragon is to take the many curves in the best line possible inside your lane.

Do NOT sightsee. The Dragon is to drive, not to watch sights. On many runs I don't even see what is on the side of the road. I'm watching the roadway way ahead.

Look far ahead at the road, curves, bushes, other vehicles, etc. If you haven't seen the hazards right in front of you, you are going to hit them anyway, so you might as well pay attention to what you have time to avoid.

We have seen deer, bear, turkeys, and wild boar on the roadway. Be ready to brake and slow down. When we say brake we DO NOT mean slamming on the brakes. That will get you turned around in a hurry and it's no fun looking at where you've been at any speed.

Maintain a "safe zone". Keep a safe distance between you and the vehicle ahead of you. Watch your rear view mirrors for faster vehicles. If you see a faster rider/driver coming up behind you, pull over to the right of your lane, slow down a little, and wave them around. It's much safer to let a faster vehicle go around you than to try to outrun them. NEVER stay left trying to keep someone from passing you. NEVER pull off the road onto the shoulder unless it is at one of the pull-off parking areas. It may be illegal to pass on the Dragon, but I'll let a faster vehicle get around me to protect my safe zone.

There will always be faster drivers than you. Don't try to be the King of the Dragon. Drive the Dragon many times before trying to challenge it. Even then you still need to respect it at all times.

DO NOT STAND ON THE BRAKES if you see danger ahead. You are much better off to tap the brakes and maintain control. Some 90% of the accidents on the Dragon are due to speed and then over braking. If you see another vehicle coming at you in your lane, hug the white line in your lane. In all likelihood you can avoid trucks and trailers if you stay alert and watch ahead.

DO NOT be spooked by other vehicles. DO NOT make sudden avoidance moves. You might have to adjust your line to avoid a car, truck, or bike, but DO NOT lay on the brakes or turn off the roadway suddenly unless that is the only out you have. Motorcycles might dent your car, but that is better than going off the bank and hitting a tree sideways. If a cycle is in your lane, that is their mistake and problem, don't let them force you into a worse situation for yourself.

Trucks are usually traveling at a very slow speed and you should have time to stop and back-up if you see one coming at you and taking the whole corner. Watch for signals from drivers/riders coming at you. Many times they will escort a big truck over the Dragon and wave a warning to you to pull over. DO NOT ignore these warnings.

Safety on the Dragon! (continued)

Avoid driving hard on the Dragon in heavy traffic times. Weekends from 11 am to 5 pm are the busiest. These are the times to lay back and enjoy watching the "show" go by. The early mornings (before 11 am) and the late afternoons (after 5 pm) have the least traffic. Always stay 100% alert. You do not have the advantage of relaxing on the Dragon

Make sure your vehicle is mechanically sound and that your tires are good. Plan to make several runs, the first is always a nervous one then you can have fun on the second and third.

DO NOT over-use your brakes. Use your gears and DOWNSHIFT. A good Dragon driver WILL NOT use a lot of brakes.

Focus - do not daydream. Watch the road, your mirrors, and pay attention to other biker/car/trucks. 99% of the accidents on the Dragon come from the following:

Too much speed - Too much brakes - Inattentiveness - Driving above your abilities



Graham County Food Drive

Once again we will be reaching out to help support the Graham County Food Pantry and give back to the local folks in the area. We have several incentives to get everyone involved:

Donations at the the Registration Room: ToddsModds has donated MOTD stickers and Craven Speed has donated Key Fobs for the first 400 people that bring 4 or more canned goods or a cash donation to registration.

Dragon Bingo: PittStop MINIs will offer 5 extra Bingo sheets for any players who bring one or more food items or donate money to the food bank at the event.

Dragon Parade: XIEK will have a custom "Motoring CD" available for a single food donation at the start of the Dragon Parade.

Here is a list of items in need: (please check the expiration dates)

Cereals

Pasta

Assorted Canned Goods

Macaroni & Cheese

Diapers (size 2-5)

Rice

Kleenex

Lotion

Oatmeal

Soups

Peanut Butter

Crackers (assorted)

An event of this size does not happen by itself. It takes a coordinated effort from a lot of individuals and groups. So let's all thank the following contributors and supporters of the 2014 MINIs on the Dragon!!

2014 Vendors and Sponsors

Alicyn Drew Photography	Group 4 Autosports	MINIBee's Motoring Merchandise
AutoXCooper	GT Peace Automotive	MINIS in the Ozark
Craven Speed	Helix Motorsports	MINIUSA
Croftgate USA of Orlando	Hendrick MINI	Out Motoring
DDMWorks	Imperial MINI	Renew Protect
Dent Removal by Marc	J Adam Sowers Photography	Revolution MINI Works
Detroit Tuned Digital	M7 Speed	Smoky Mountain Cabins
Vision Gallery Extreme	MC2 Magazine	Stuck on MINIs
Colors of SC Fontana	MINI FINI	ToddsModds
Village	MINI of Tampa Bay	Way Motor Works
Graham County	MINI Skirts	

2014 Event and Drive Volunteers

Al Lopez	Jason Hurdle - XIEK
Alan & Bev Miller	Jay & Norma Jean Pecotte
Alicyn Drew	Jeff Ellis
AutoXCooper.com	Johnny Cee
Barry & Robin Patascher	Lelane Lemond
Becky & Luis Mendez	Leon Dixon
Bill Connelly	Mark & Barbara Shadwell
Bill Derr	MKO
Bob & Ginny Pearcy	Mid-Ohio Motoring
Carl Bauersfeld	Mike & Donna Smith
Celia Seminerio	MINI of Knoxville
Central Maryland MINI Motorist	MINI Skirts
Chad & Tracey Roth	Motoring Alliance
Chris & Melissa Bastin	Nathan Freedenberg
Christopher Norrick	Out Motoring
Craig McVeay	Philly MINI
David & Lisa Fitchena	PittSop MINI
Detroit Tuned	Rick & Ann Byrum
Erin Kirk-Cuomo	Rhonda Sawyer
Fred Fisher	Shey & Teri Knight
George Ancheta	Smoky Mountain Cabins
Gigi Lewling	Steve Quees
Hampton Roads MINI Club	Sunshine MINIs
Hendrick MINI	Todd & Debbie Jeffery
Jack Rowland	Tom & Vyndi Womble
Janet Ford	Way Motor Works
	Woody & Barbie Marshall

Wednesday - April 30th 2014

- 6:30 am - 11:30 am Smoky Mtn. Sunrise Drive
- 7:00 am - 10:30 am Glamour Shots-Morning
- 9:00 am - 3:45 pm Smoky Mtn. Alpine Coaster
- 2:00 pm - 4:00 pm Dragon Safety
- 2:00 pm - 5:00 pm Registration Pick-Ups
- 3:00 pm - 6:00 pm Glamour Shots-Afternoon
- 6:00 pm - 8:00 pm Welcome Dinner
- 8:00 pm - 10:00 pm Cigar Salon
- 8:00 pm - 10:00 pm Wine Tasting
- 8:00 pm - 10:00 pm Skirtstock

Thursday - May 1st 2014

- 6:00 am - 11:00 am Sunrise Drive
- 7:45 am - 2:15 pm Dry Falls and Bridal Veil Falls
- 8:00 am - 4:30 pm Gatlinburg Craftsman Loop
- 8:15 am - 3:30 pm Cades Cove Loop
- 8:30 am - 2:30 pm Lost Sea Run - Thursday
- 8:45 am - 1:30 pm Dragon Fire - Thursday Run
- 9:00 am - 11:00 am Registration Pick-Ups
- 9:00 am - 2:30 pm Deep Creek Waterfalls
- 9:15 am - 3:00 pm White Water Rafting
- 9:30 am - 1:30 pm Wayah Road to Franklin
- 9:45 am - 2:45 pm Winery and Lunch
- 10:00 am - 3:00 pm Brewery Drive and Lunch
- 10:00 am - 2:00 pm Quilt Tour
- 11:00 pm - 3:00 pm Hazel Creek Tour
- 11:30 am - 6:00 pm Dry Falls / Bridal Veil Falls
- 1:30 pm - 6:30 pm Cherohala and Dinner
- 2:00 pm - 4:00 pm Registration Pick-Ups
- 3:30 pm - 6:00 pm River's End Dinner - Janet
- 3:30 pm - 6:00 pm Papa's Pizza in Robbinsville
- 4:00 pm - 5:00 pm Exhaust Sound Off
- 6:30 pm - 9:30 pm Bingo
- 8:00 pm - 10:00 pm Way's Tent Party
- 9:45 pm - 10:00 pm Firework Show

Friday - May 2nd 2014

- 7:00 am - 9:00 am Glamour Shots
- 7:30 am - 11:30 am Donut Run

Friday - May 2nd 2014 - Continued

- 8:00 am - 9:30 am Dragon Parade
- 8:45 am - 1:30 pm Dragon Fire - Friday Run
- 9:00 am - 11:00 am Registration Pick-Ups
- 9:00 am - 5:00 pm Zipline
- 9:00 am - 2:30 pm Lost Sea - Friday Run
- 9:30 am - 3:00 pm Cherohala and Lunch - Early
- 9:45 am - 3:15 pm Lunch in Murphy NC
- 10:00 am - Cabin Decorating Voting Starts
- 10:00 am - 3:30 pm Cherohala and Lunch - Late
- 10:15 am - 3:15 pm Brewery Drive and Lunch
- 11:00 am - 3:00 pm Hazel Creek Tour
- 11:30 am - 1:30 pm Poker Run
- 1:30 pm - 4:00 pm Burger Run
- 2:00 pm - 4:00 pm Registration Pick-Ups
- 2:00 pm - 5:00 pm MINI Glamour Photo Shoot
- 2:15 pm - 8:45 pm Mingus Mill - Balsam Mtn. Inn
- 2:30 pm - 4:00 pm Kickball
- 3:00 pm - 10:00 pm Mingo Falls - Oconaluftee
- 3:30 pm - 6:00 pm River's End Dinner - Snooter
- 3:30 pm - 6:00 pm Papa's Pizza in Robbinsville
- 6:00 pm - 8:00 pm Brewswap
- 7:30 pm - 10:30 pm Drive-In Movie
- 8:00 pm - 11:00 pm Karaoke

Saturday - May 3rd 2014

- 8:00 am - 5:15 pm Biltmore Drive and Lunch
- 8:45 am - 1:30 pm Dragon Fire - Saturday Run
- 9:00 am - 11:00 am Registration Pick-Ups
- 10:00 am - 11:00 am Panoramic Photo
- 11:15 am - 2:30 pm Ice Cream Run
- 11:15 am - 3:15 pm Countrymen on Parsons Branch
- 11:30 am - 3:45 pm Shotguns at the Dragon
- 1:15 pm - 4:30 pm Nantahala Brewery Lunch
- 2:00 pm - 4:00 pm Car Show
- 2:30 pm - 3:00 pm GP Photo Shoot
- 6:00 pm - 8:00 pm Farewell Dinner
- 8:45 pm - 11:15 pm Twilight N Twisites
- 11:00 pm - 1:00 am Midnight Run

Schedule of Events

Wednesday - April 30th 2014

Smoky Mtn. Sunrise Drive	Host: Bill Derr
Time: 6:30 am - 11:30 am	
Location: General Store Parking Lot	
Glamour Shots	Host: Craig McVeay and Alicyn Drew
Time: 7:00 am - 10:30 am	
Location: Boat Ramp on the Hellbender	
Smoky Mtn. Alpine Coaster	Host: Chad and Tracey Roth
Time: 9:00 am - 3:45 pm	
Location: General Store Parking Lot	
Dragon Safety	Host: Jack Rowland
Time: 2:00 pm - 4:00 pm	
Location: The Blue Ridge Room in the Lower Level of the Main Lodge Building	
Registration Pick-ups	Host: Nathan Freedenberg
Time: 2:00 pm - 5:00 pm	
Location: Card Room inside the Rec. Hall Building at Fontana Village	
Glamour Shots	Host: Craig McVeay and Alicyn Drew
Time: 3:00 pm - 6:00 pm	
Location: Boat Ramp on the Hellbender	
Welcome Dinner	Host: Sunshine MINIs (doors open at 5:00)
Time: 6:00 pm - 8:00 pm	
Location: Rec. Hall at Fontana Village	
Cigar Salon	Host: Jack Rowland
Time: 8:00 pm - 10:00 pm	
Location: Front Porch of the Rec. Hall at Fontana Village	
Wine Tasting	Host: AutoXCooper, Alan and Bev Miller
Time: 8:00 pm - 10:00 pm	
Location: Rec. Hall at Fontana Village	
SkirtaPalooza: Party Gras	Host: The MINISkirts
Time: 8:00 pm - 10:00 pm	
Location: Outdoor Deck between the Rec. Hall and Wildwood Grill at Fontana	

Thursday - May 1st 2014

Sunrise Drive	Host: Janet Ford
Time: 6:00 am - 11:00 am	
Location: General Store Parking Lot	
Dry Falls and Bridal Veil Falls	Host: Philly MINI
Time: 7:45 am - 2:15 pm	
Location: General Store Parking Lot	
Gatlinburg Craftsman Loop	Host: Bob and Ginny Pearcy
Time: 8:00 am - 4:30 pm	
Location: General Store Parking Lot	
Cades Cove Loop	Host: Woody and Barbie Marshall
Time: 8:15 am - 3:30 pm	
Location: Lower Dam Parking Lot	

Thursday (continued) - May 1st 2014

Lost Sea Run - Thursday	Host: Mark and Barbara Shadewell
Time: 8:30 am - 2:30 pm	
Location: General Store Parking Lot	
Dragon Fire - Thursday Run	Host: Alan and Bev Miller
Time: 8:45 am - 1:30 pm	
Location: General Store Parking Lot (upper end, not in front of the General Store)	
Registration Pick-Ups	Host: Nathan Freedenberg
Time: 9:00 am - 11:00 am	
Location: Card Room inside the Rec. Hall Building at Fontana Village	
Deep Creek Waterfalls	Host: Christopher Norrick
Time: 9:00 am - 2:30 pm	
Location: General Store Parking Lot	
White Water Rafting	Host: Tom Womble
Time: 9:15 am - 3:00 pm	
Location: General Store Parking Lot	
Wayah Road to Franklin	Host: Rick and Ann Byrum
Time: 9:30 am - 1:30 pm	
Location: General Store Parking Lot	
Winery and Lunch	Host: Shey and Teri Knight
Time: 9:45 am - 2:45 pm	
Location: General Store Parking Lot	
Brewery Drive and Lunch	Host: Carl Bauersfeld
Time: 10:00 am - 3:00 pm	
Location: General Store Parking Lot	
Quilt Tour	Host: Cyndi Womble
Time: 10:00 am - 2:00 pm	
Location: Stecoah Cultural Arts Center	
Fontana Lake and Hazel Creek	Host: JP from Fontana Village
Time: 11:00 pm - 3:00 pm	
Location: Fontana Marina	
Dry Falls and Bridal Veil Falls	Host: Jack Rowland
Time: 11:30 am - 6:00 pm	
Location: General Store Parking Lot	
Cherohala and Dinner	Host: Fred Fisher
Time: 1:30 pm - 6:30 pm	
Location: General Store Parking Lot	
Registration Pick-Ups	Host: Nathan Freedenberg
Time: 2:00 pm - 4:00 pm	
Location: Card Room inside the Rec. Hall Building at Fontana Village	
River's End Dinner	Host: Janet Ford
Time: 3:30 pm - 6:00 pm	
Location: Old Registration Building Parking Lot	

Thursday (continued) - May 1st 2014

Papa's Pizza in Robbinsville	Host: David and Lisa Fitchena
Time: 3:30 pm - 6:00 pm	
Location: General Store Parking Lot	
Exhaust Sound Off	Host: AutoXCooper
Time: 4:00 pm - 5:00 pm	
Location: General Store Parking Lot	
Bingo	Host: PitStop MINIs (doors open at 5:30)
Time: 6:30 pm - 9:30 pm	
Location: Rec. Hall at Fontana Village	
Way's Tent Party	Host: Way Motor Works
Time: 8:00 pm - 10:00 pm	
Location: Way Motor Works Tent in the Vendor Alley	
Fireworks	Host: Snooter and Fontana Village
Time: 9:45 pm - 10:00 pm	
Location: Fireworks will be shot from the Baseball Field at Fontana	

Friday - May 2nd 2014

Glamour Shots	Host: Craig McVeay and Alicyn Drew
Time: 7:00 am - 9:00 am	
Location: Boat Ramp on the Hellbender	
Donut Run	Host: Motoring Alliance & Mid-Ohio Motoring
Time: 7:30 am - 11:30 am	
Location: General Store Parking Lot	
Dragon Parade	Host: Jason "XIEK" Hurdle
Time: 8:00 am - 9:30 am	
Location: Lower Dam Parking Lot	
Dragon Fire - Friday Run	Host: Leland Lemond
Time: 8:45 am - 1:30 pm	
Location: General Store Parking Lot	
Registration Pick-Ups	Host: Bill Connelly
Time: 9:00 am - 11:00 am	
Location: Card Room inside the Rec. Hall Building at Fontana Village	
Zipline	Host: Johnny Cee
Time: 9:00 am - 5:00 pm	
Location: Paved Lot at the End of the Dragon	
Lost Sea - Friday Run	Host: George Ancheta
Time: 9:00 am - 2:30 pm	
Location: Paved Lot at the End of the Dragon	
Cherohala Lunch - Early Run	Host: Mike and Donna Smith
Time: 9:30 am - 3:00 pm	
Location: General Store Parking Lot	
Lunch in Murphy	Host: MINI Skirts
Time: 9:45 am - 3:15 pm	
Location: General Store Parking Lot	

Friday (continued)- May 2nd 2014

Cabin Decoration Voting	Host: Hendrick MINI
Time: 10:00 am - (24hr voting window begins)	
Location: Pick-up Ballots at the Hendrick MINI Tent	
Cherohala Lunch - Late Run	Host: Jack Rowland
Time: 10:00 am - 3:30 pm	
Location: General Store Parking Lot	
Brewery Drive and Lunch	Host: Jay and Norma Jean Pecotte
Time: 10:15 am - 3:15 pm	
Location: General Store Parking Lot	
Lake Fontana and Hazel Creek	Host: Jonathan People from Fontana
Time: 11:00 am - 3:00 pm	
Location: Fontana Marina	
Poker Run	Host: Cental Maryland MINI Motorist
Time: 11:30 am - 1:30 pm	
Location: General Store Parking Lot	
PittsBurger Run	Host: PttStop MINIs
Time: 1:30 pm - 4:00 pm	
Location: General Store Parking Lot	
Registration Pick-Ups	Host: Nathan Freedenberg
Time: 2:00 pm - 4:00 pm	
Location: Card Room inside the Rec. Hall Building at Fontana Village	
Mingus Mill - Balsam Mtn. Inn	Host: Woody and Barbie Marshall
Time: 2:15 pm - 8:45 pm	
Location: General Store Parking Lot	
Kickball	Host: Al Lopez
Time: 2:30 pm - 4:00 pm	
Location: Baseball Field at Fontana Village	
Mingo Falls and Oconaluftee Village	Host: Tom Womble
Time: 3:00 pm - 10:00 pm	
Location: General Store Parking Lot	
River's End Dinner	Host: Barry and Robin Patascher
Time: 3:30 pm - 6:00 pm	
Location: Old Registration Building Parking Lot	
Papa's Pizza in Robbinsville	Host: Bob and Ginney Percy
Time: 3:30 pm - 6:00 pm	
Location: General Store Parking Lot	
BrewSwap	Host: Detroit Tuned
Time: 6:00 pm - 8:00 pm	
Location: Rec. Hall at Fontana Village	
Drive in Movie	Host: MINI of Knoxville and HR MINI
Time: 7:30 pm - 10:30 pm	
Location: Baseball Field at Fontana Village	
Karaoke	Host: Snooter
Time: 8:00 pm - 11:00 pm	
Location: Rec. Hall at Fontana Village	

Saturday - May 3rd 2014

Biltmore Drive and Lunch	Host: Rhonda Sawyer and Steve Queen
Time: 8:00 am - 5:15 pm	
Location: General Store Parking Lot	
Dragon Fire - Saturday Run	Host: Chris and Melissa Bastin
Time: 8:45 am - 1:30 pm	
Location: General Store Parking Lot	
Registration Pick-Ups	Host: Nathan Freedenberg
Time: 9:00 am - 11:00 am	
Location: Card Room inside the Rec. Hall Building at Fontana Village	
Panoramic Photo	Host: Atlanta Panoramic
Time: 10:00 am - 11:00 am	
Location: Baseball Field at Fontana Village	
Ice Cream Run	Host: Alan and Bev Miller
Time: 11:15 am - 2:30 pm	Ice Cream Run
Location: Line up on Welch Road (the end furthest away from the General Store)	
Countrymen on Parsons Branch	Host: Erin Kirk-Cuomo
Time: 11:15 am - 3:15 pm	
Location: General Store Parking Lot	
Shotguns at the Dragon	Host: Luis and Becky Mendez
Time: 11:30 am - 3:45 pm	
Location: General Store Parking Lot	
Nantahala Brewery Lunch	Host: Alan and Bev Miller
Time: 1:15 pm - 4:30 pm	
Location: In Front of Soda Pops Ice Cream Store in Bryson City	
Car Show	Host: Outmotoring and Bill Connelly
Time: 2:00 pm - 4:00 pm	
Location: Baseball Field at Fontana Village	
GP Photo Shoot	Host: Todd and Debbie Jeffery
Time: 2:30 pm - 3:00 pm	
Location: Parking Lot at the end of Deep Creek Campgrounds	
Farewell Dinner	Host: Snooter
Time: 6:00 pm - 8:00 pm	(doors open at 5:30)
Location: Rec. Hall at Fontana Village	
Twilight N Twisties	Host: Jack Rowland
Time: 8:45 pm - 11:15 pm	
Location: General Store Parking Lot	
Midnight Run	Host: MKO
Time: 11:00 pm - 1:00 am	
Location: General Store Parking Lot	

Vendor Alley Layout

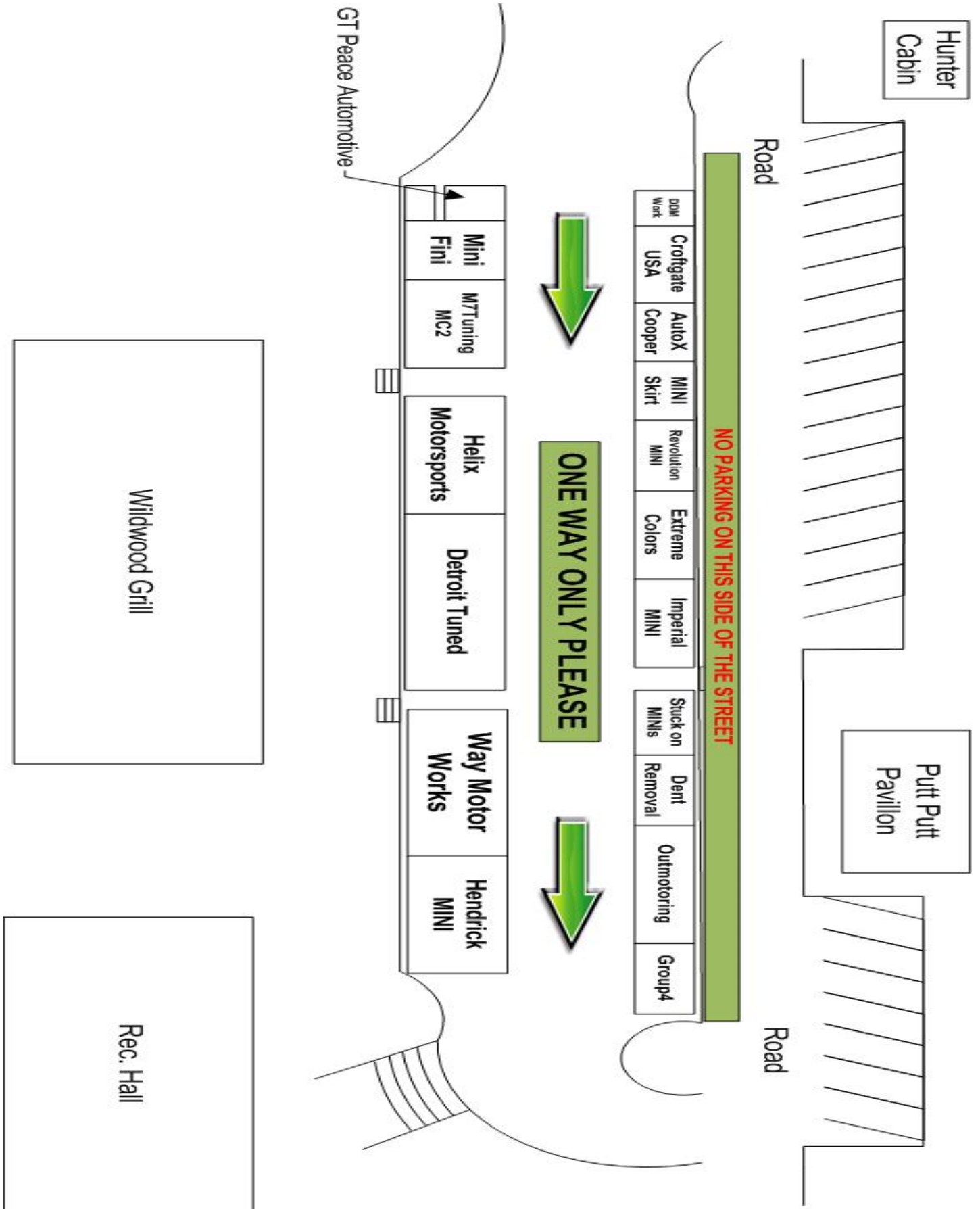

Vendor Schedule

Vendor Name	Dates Available	Location
AutoXCooper	Thursday - Saturday	Vendor Alley
Croftgate USA of Orlando	Thursday - Saturday	Vendor Alley
DDM Works	Friday - Saturday	Vendor Alley
Dent Removal by Marc	Wednesday - Saturday	Vendor Alley
Detroit Tuned	Wednesday - Saturday	Vendor Alley
Extreme Colors	Wednesday - Saturday	Vendor Alley
Group 4 Motorsports	Wednesday - Saturday	Vendor Alley
GT Peace Automotive	Wednesday - Saturday	Vendor Alley
Helix Motorsports	Wednesday - Saturday	Vendor Alley
Hendrick MINI	Wednesday - Saturday	Vendor Alley
Imperial MINI	Wednesday - Saturday	Vendor Alley
M7 Speed	Wednesday - Saturday	Vendor Alley
MC2 Magazine	Wednesday - Saturday	Vendor Alley
MINIBee's Motoring Merchandise	Wednesday: At Welcome Dinner Thursday: 9-11 outside reg. room Thursday: At Bingo	Friday: 8-9pm at Karaoke Saturday: At Farewell Dinner
MINIFINI	Wednesday - Saturday	Vendor Alley
MINI Skirts	Thursday - Saturday	Vendor Alley
OutMotoring	Wednesday - Saturday	Vendor Alley
Revolution MINI Works	Wednesday - Saturday	Vendor Alley
Stuck on MINIs	Wednesday - Saturday	Vendor Alley
Way Motor Works	Tuesday - Saturday	Vendor Alley

MOTD Restaurant Guide

Wildwood Grill At Fontana
828-498-2211

The Bistro at Fontana
828-498-2211

Deals Gap Grill
17548 Tapoco Road
Robbinsville, NC 28771
828-498-2231

Pacifico Mexican Rest.
429 Rodney Orr Byp. (US-129)
Robbinsville, NC
828-479-2431

Na-Bers Drive In
1245 Main Street
Bryson City, NC 28713
828-488-2877

Dragon Pitt BBQ
4407 Calderwood Hwy
Maryville, TN 37801
(865) 253-3566

Carolina Kitchen
400 Rodney Orr Byp (US-129)
Robbinsville, NC
828-479-1500

River's End
13077 hwy 19 west
Bryson City, NC 28713
828-488-2176

Papa's Pizza
211 Tapoco Road
Robbinsville, NC 28771
828-479-2431

Huddle House
610 Tallulah Road (US-129)
Robbinsville, NC
828-479-9695

Yummi Yummi Buffett
33 Rector St
Bryson City, NC 28713
828-488-1240

Lynn's Place
237 E. Main Street
Robbinsville, NC 28771
828-479-9777

The Filling Station & Subs
145 Everett Street
Bryson City, NC
828-488-1919

Anthony's Rest. & Pizzeria
15 Depot St
Bryson City, NC 28713
828-488-8898

McDonalds
374 Rodney Orr Byp
Robbinsville, NC 28771
828-479-6776

Fryemont Inn and Restaurant
245 Fryemont Street
Bryson City, NC
800-845-4879

Jimmy Mac's Restaurant
121 Main Street
Bryson City, NC 28713
828-488-4700

Wendy's
347 Old Hwy 129
Robbinsville, NC 28771
828-479-4755

Guayabitos Mexican Restaurant
239 US-19 South
Bryson City, NC
828-488-1336

Jarrett House
101 E. Haywood Road
Dillsboro, NC
828) 586-6251

Phillips Smoky Mtn. Rest.
146 E. Main Street
Robbinsville, NC 28771
828-479-8811

Everett Street Dinner
126 Everett Street
Bryson City, NC
828-488-0123

Kosta's Greek Restaurant
489 Haywood Road
Dillsboro, NC
828-631-0777

EMERGENCY INFORMATION

If you have cell coverage call 911. If you don't not have cell coverage try to make your way to an establishment such as Fontana Village or The Crossroads of Time. Other helpful numbers:

Cheoah Ranger Station - NC	828-479-6431	1133 Massey Branch Road - Robbinsville - NC - 28771
Tellico Ranger Station - TN	423-253-2520	250 Ran Station Road - Tellico Plains - TN - 37385
Graham County Sheriff - NC	828-479-3352	
Monroe Sheriff Dept- TN	423-442-3911	

There is also a TVA Police station located at the top of the Fontana Dam near the Visitor's Center. The closest hospital is Swain County in Bryson City. As a reminder, none of the drives are a race. Please drive safely, obey all traffic laws, and stay alert for changing road conditions.

History of MINIs on the Dragon

In May of 2003, the first group of Miniacs went to conquer the Dragon. Sixty cars in number and strong in spirit the first Dragon slayers were excited to come back and tell the rest of the world of their adventure. It was this group that ordained that the first weekend in May, they would return, bringing as many MINI friends as possible. Each year since, the daily events and host have changed, but the essence of the event remains. MINIs, Twisties and Friends sharing the common bond of a fun car and a great road.

FONTANA VILLAGE RESORT

Fontana Village is exactly that: a village. It was originally built to house the workers building the nearby Fontana Dam in 1942. This small town contained everything needed to support the workers building the tallest dam on the East Coast: a general store, school, post office, hospital, church, even a police and fire department. As you travel around the resort you can see these buildings, some of which are still in use today. The dam was completed in 1945, and in 1947 the village was turned into the largest resort in the Smoky Mountains.

THE CHEROHALA SKYWAY

One of the region's more popular roads. Built along portions of a former Cherokee Indian trading route, this 40 mile road took over 30 years to build and cost \$100 million. Scenery along this route rivals the Blue Ridge Parkway and includes elevations up to 5,390 ft. Drive time can range from 90 minutes to 2 hours depending on the number of stops you make.

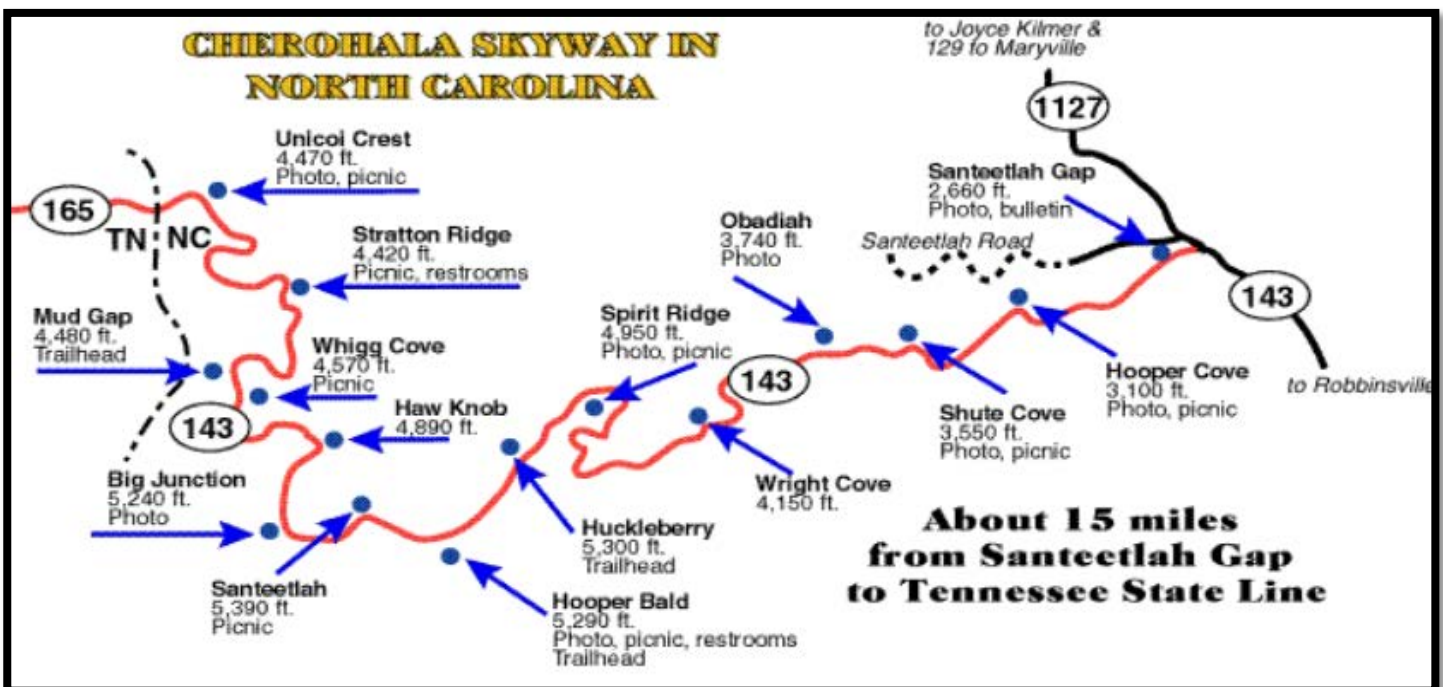

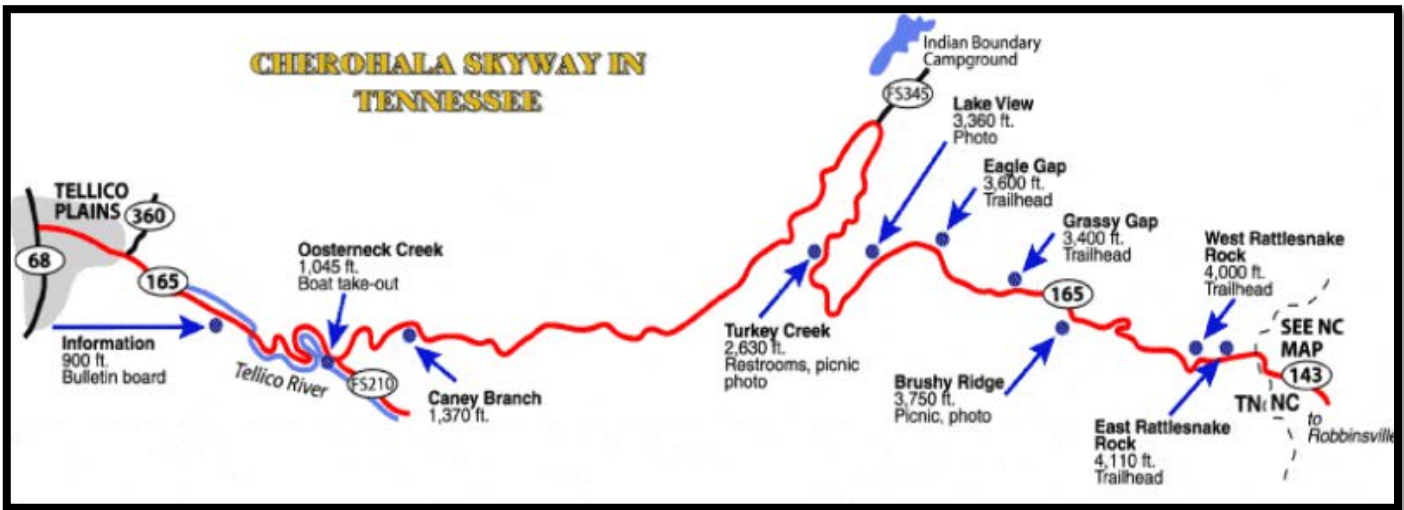

Highlands and Waterfalls



Bridal Veil Falls - 2.5 mi. east of Highlands on U.S. 64. Visible from the highway, which at one time routed traffic under the falls. Height 120 ft.

Cullasaja Falls - Visible from U.S. 64, in Cullasaja Gorge, 11 mi. east from Franklin, 9 mi. west from Highlands. Height 250 ft. Accessible by foot trail, a half-mile through steep, rough terrain.

Dry Falls - Located near U.S. 64, 3.5 mi. west from Highlands, 16.5 mi. east from Franklin. Paved walkway leads to falls from parking area. Walk underneath the 75 ft. falls.

Glen Falls - From Highlands, travel 3 mi. south on NC 106. Turn left on U.S. Forest Service Rd. with "Glen Falls" marker. One-mile trail to falls is steep and rough. Consists of three large falls, each dropping approx. 60 feet.

Whitewater Falls - At 411 ft., the highest falls in Eastern America. From Cashiers, take U.S. 64 east, 10 mi. to "Whitewater Road." Falls are located 10 mi. south on Whitewater Rd., near the NC-SC state line.

